



CLINTON TOWNSHIP, MI
586.790.6100
HOLLY SPRINGS, MS
662.252.1421
ROURAMH.COM

ULTIMATE HOPPER

4T-1/4-675 2.5 CU. YD



CONSTRUCTION:

- 1/4" plate body & 2 rows of reinforced angle.
- 5/16" formed box tube base.
 - Body is 100% continuous weld
- Standard Items:
 - Steel Handle
 - Secure Flip Latch
 - Mast Secure Chain
 - Continuous Stops & Base to Body Chains
- Painted Roura Green (other colors optional)
- Optional Items are Available [Here](#)

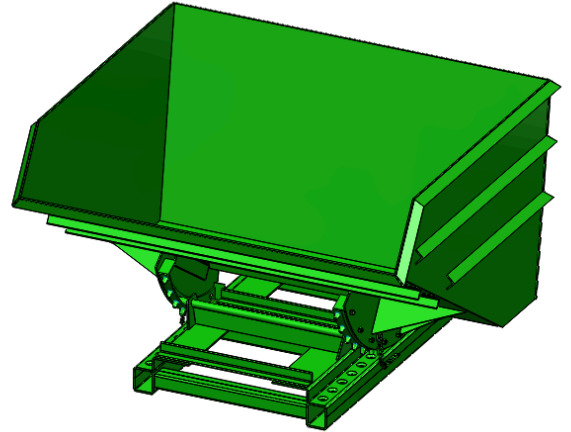

ULTIMATE 4T-1/4-675

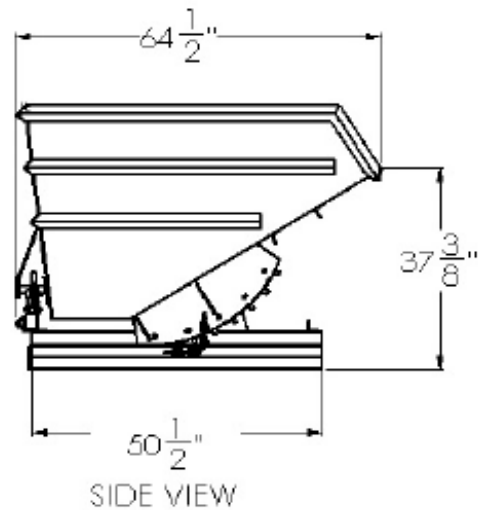
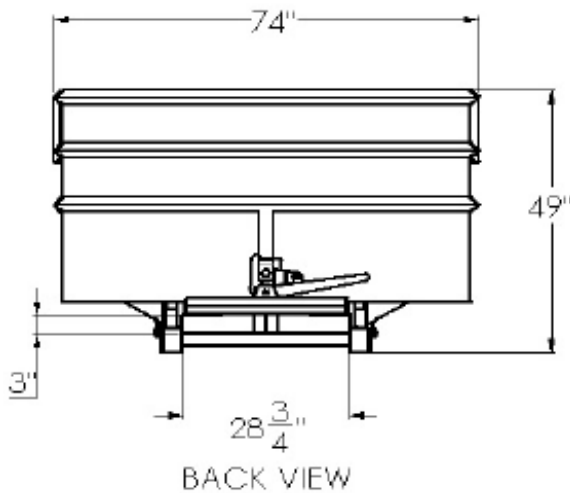

MODEL #	SIZE	L	W	H	LH	FORK OPENING	LOAD CAPACITY	WEIGHT
4T-1/4-675	2.5 CU. YD	64 1/2"	74"	49"	37 3/8"	3" X 28 3/4"	8,000 LBS	1395 LBS

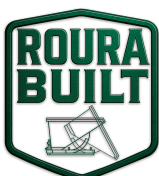

“FOR ALL OF YOUR MATERIAL HANDLING NEEDS!”