



CLINTON TOWNSHIP, MI
586.790.6100
HOLLY SPRINGS, MS
662.252.1421
ROURAMH.COM

RUGGED HOPPER

3T-3/16-1080 4 CU. YD



CONSTRUCTION:

- 7 gauge plate body & 5/16" formed plate base.
 - Body is 100% continuous weld
- Standard Items:
 - Ductile Iron Handle
 - Secure Flip Latch
 - Mast Secure Chain
 - Continuous Stops
- Painted Roura Green (other colors optional)
- Optional Items are Available [Here](#)

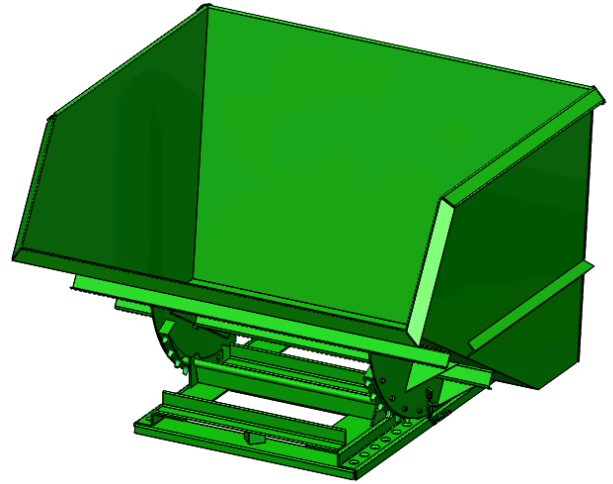

RUGGED 3T-3/16-1080

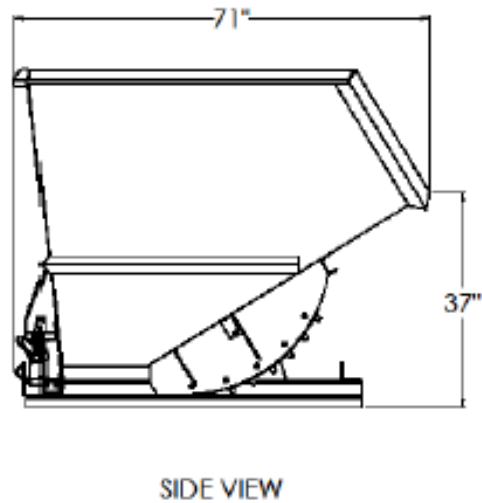
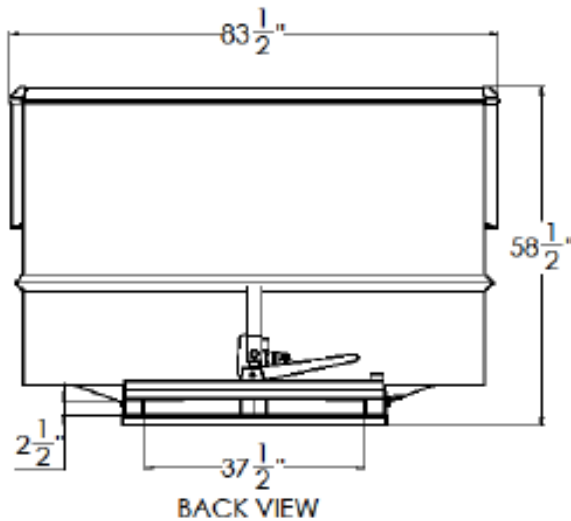

MODEL #	SIZE	L	W	H	LH	FORK OPENING	LOAD CAPACITY	WEIGHT
3T-3/16-1080	4 CU. YD	71"	83 1/2"	58 1/2"	37"	2 1/2" X 37 1/2"	6,000 LBS	1287 LBS

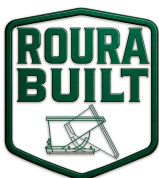

“FOR ALL OF YOUR MATERIAL HANDLING NEEDS!”