

RTB-DUR-405 (DURABLE ROTATOR BOX) 2000 LBS

| MODEL # | L | W | H | WEIGHT |
|-------------|-----|-----|---------|---------|
| RTB-DUR-405 | 47" | 47" | 40 3/8" | 447 LBS |

1 1/2 YARD VOLUME CAPACITY

The Durable Rotator Box is designed for the collection and storage of bulk and scrap material. This box can be dumped using a forklift equipped with a rotational fork attachment. The standard model is made of all welded carbon steel with drain plug and 4-way fork entry.

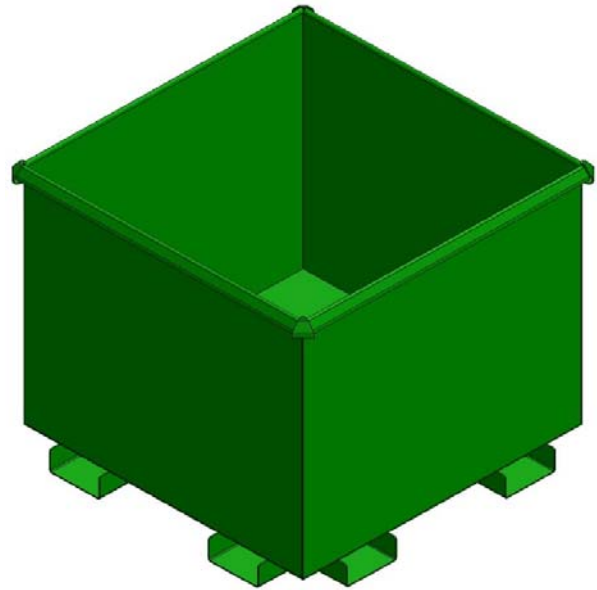

Michigan: (800) 968-9070

Mississippi: (800) 654-9147

rourahm.com

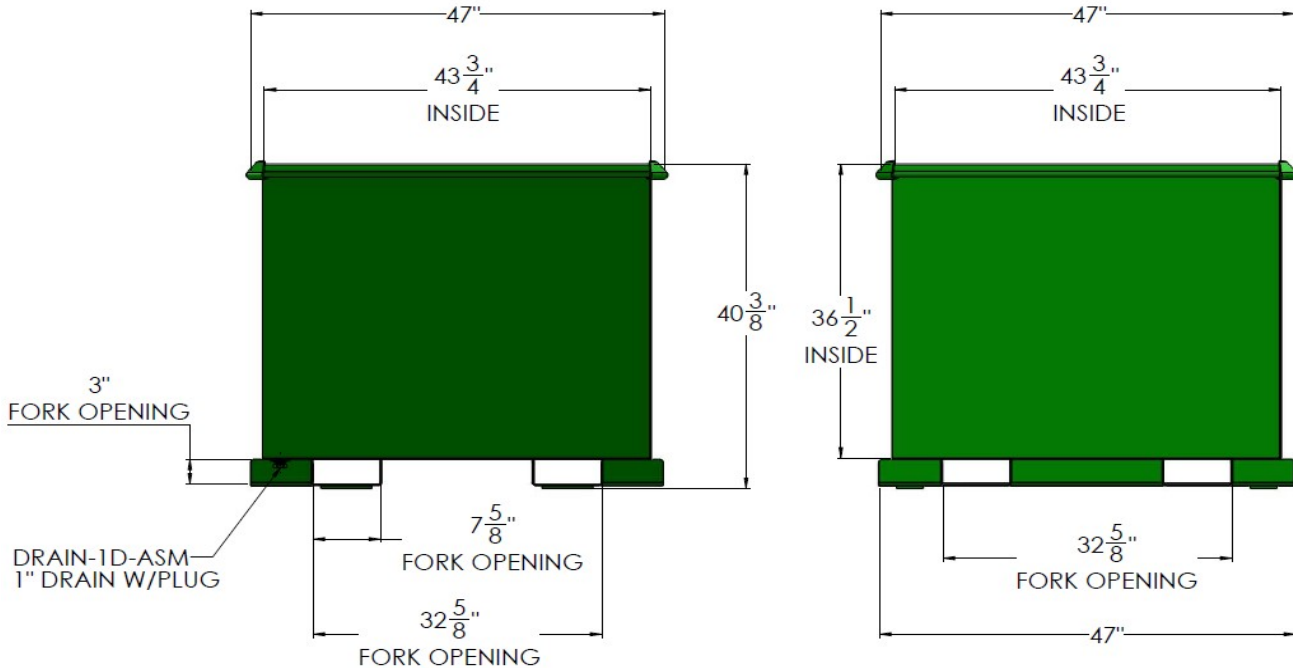

- 7 GAUGE STEEL BOTTOM WITH DRAIN AND PLUG, 10 GAUGE STEEL FORMED SIDES. BOX TUBE FORK OPENINGS FOR SUPERIOR STRENGTH WITH SKID PLATES.
- 2000 LBS. MAX LOAD CAPACITY.
- BRIGHT SAFETY GREEN ENAMEL PAINT (OPTIONAL COLORS AVAILABLE).
- STACKABLE (3 EMPTY BOXES HIGH RECOMMENDED).
- OPTIONS: STEEL HINGED COVER, STEEL REMOVABLE COVER, CASTERS, CRANE EYES, TARPS.
- CUSTOM SIZES ARE AVAILABLE UPON REQUEST.

"FOR ALL YOUR MATERIAL HANDLING NEEDS!"